



41 Asher Lane,
Ruddington, NG11 6HS

TJ
THOMAS
JAMES

41 Asher Lane, Ruddington, NG11 6HS

This well presented semi detached family home provides accommodation arranged over two floors including; an entrance hall, a living room, a dining kitchen, and a wc on the ground floor, with the first floor landing giving access to three bedrooms, and the bathroom.

Benefiting from UPVC double glazing and gas central heating, the property has a good size garden to the rear, and a generous size block paved driveway at the front providing off road parking for a number of vehicles.

Situated close to the heart of the sought after south Nottinghamshire village of Ruddington, the property is within walking distance of Rushcliffe Country Park, as well as a wealth of local facilities including shops, churches, a doctors surgery, and restaurants. Main road routes and local transport links give access to Nottingham, Leicester and neighbouring villages.

Viewing is recommended.

Guide Price £335,000





ACCOMMODATION

A hardwood entrance door with glazed inserts, opens to the entrance hall. The entrance hall has a stripped staircase rising to the first floor, a vertical radiator, tiled flooring, and doors opening to the living room, and the ground floor wc.

The ground floor wc is fitted with a two piece suite comprising; a low flush wc, and a wash hand basin. There is a double glazed window to the side.

The living room has a double glazed bay window to the front, a radiator, a feature brick fireplace with a tiled hearth and space for a log burning stove, built in shelving, storage and a log store.

Fitted with a range of wall, drawer and base units, tiled splash backs and roll edge work surfaces, the dining kitchen has a one and a half bowl ceramic sink and drainer unit with a mixer tap over, space and plumbing for both a washing machine and dishwasher, a built in fridge and freezer, plus a Range cooker with an extractor hood over. There are two double glazed windows to the rear, and a double glazed door opening to the side.

On reaching the first floor, the landing has a loft access hatch, a double glazed window to the side, a radiator, and doors into all three bedrooms, and the bathroom.

Bedroom one has a double glazed window to the rear, a radiator, feature wood panelling to the walls, and a range of built in wardrobes.

Bedroom two has a double glazed window to the front, and a radiator.

Bedroom three has a double glazed window to the rear, and a radiator.

Completing the accommodation, the bathroom is fitted with a three piece suite comprising; a low flush wc, a wash hand basin, and a panelled bath with a mains fed shower over. There is a heated towel rail, and a double glazed window to the side.

OUTSIDE

At the front of the property, the generous size block paved driveway provides off road parking for a number of vehicles. There is access to the entrance door, and pedestrian gated access to the side and rear.

The rear garden includes a large block paved patio seating area, and an extensive shaped lawn with stone chipped borders. The garden is timber fence enclosed, and houses a brick built outhouse for storage.

Council Tax Band

Council Tax Band B. Rushcliffe Borough Council.

Amount Payable 2024/2025 £1,915.71.

Referral Arrangement Note

Thomas James Estate Agents always refer sellers (and will offer to refer buyers) to Premier Property Lawyers, Ives & Co, and Curtis & Parkinson for conveyancing services (as above). It is your decision as to whether or not you choose to deal with these conveyancers. Should you decide to use the conveyancers named above, you should know that Thomas James Estate Agents would receive a referral fee of between £120 and £240 including VAT from them, for recommending you to them.



DISCLAIMER NOTES

These sales particulars have been prepared by Thomas James Estate Agents on the instruction of the vendor. Services, equipment and fittings mentioned in these particulars have NOT been tested, and as such, no warranties can be given. Prospective purchasers are advised to make their own enquiries regarding such matters. These sales particulars are produced in good faith and are not intended to form part of a contract. Whilst Thomas James Estate Agents have taken care in obtaining internal measurements, they should only be regarded as approximate.

MONEY LAUNDERING

Under the Protecting Against Money Laundering and the Proceeds of Crime Act 2002, Thomas James require any successful purchasers proceeding with a purchase to provide two forms of identification i.e passport or photocard driving license and a recent utility bill. This evidence will be required prior to Thomas James instructing solicitors in the purchase or the sale of a property.

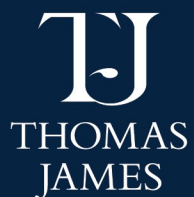
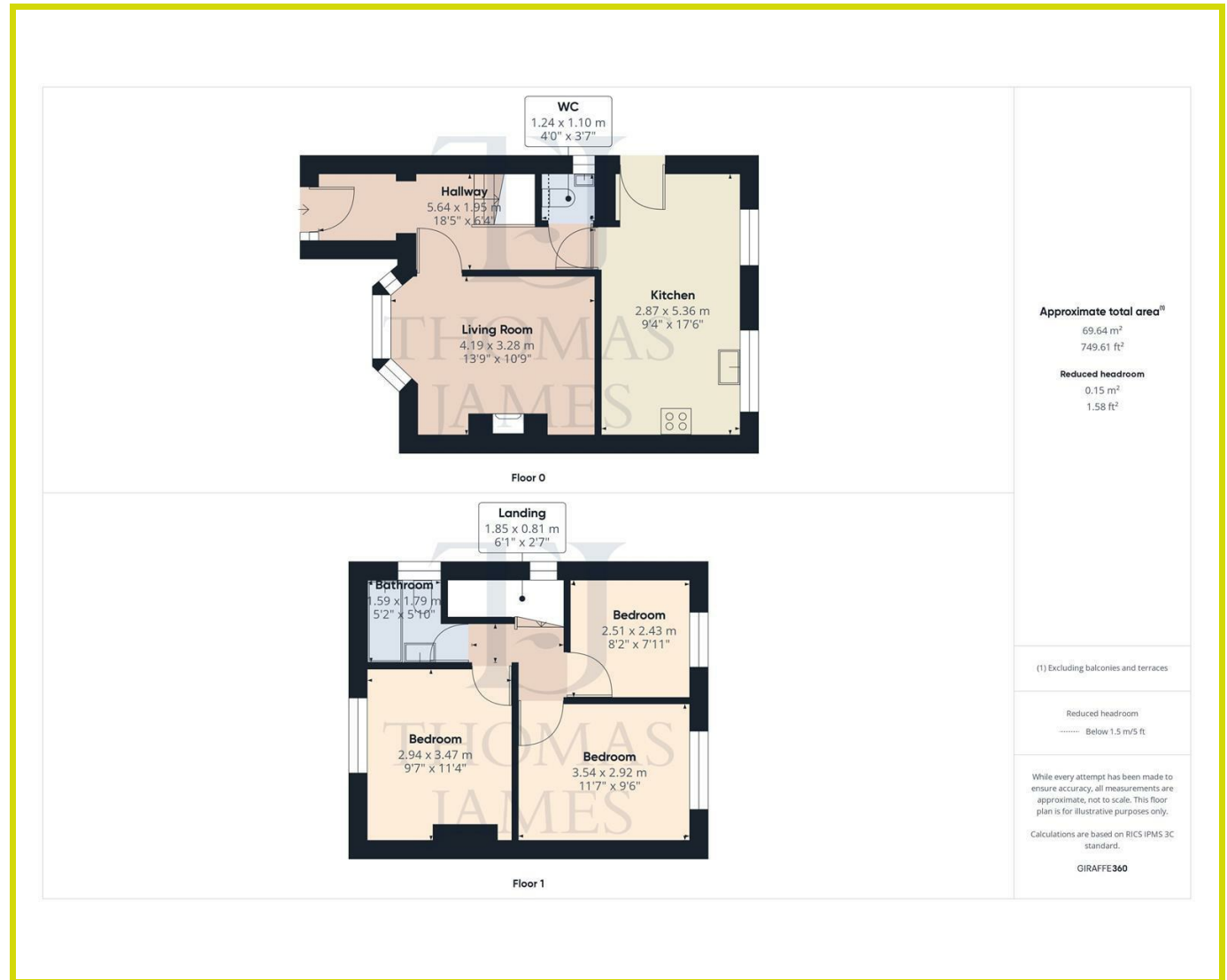
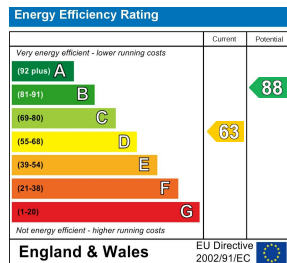

Thomas James Estate Agents, 20 High Street, Ruddington, Nottinghamshire, NG11 6EH

Tel: 0115 9844660 | Email: ruddington@tjea.com | Web: www.tjea.com

These particulars, whilst believed to be accurate are set out as a general outline only for guidance and do not constitute any part of an offer or contract. Intending purchasers should not rely on them as statements of representation of fact, but must satisfy themselves by inspection or otherwise as to their accuracy. No person in this firm's employment has the authority to make or give any representation or warranty in respect of the property.

